

BUMP TRAPS

Bench Scale Rotary Evaporators

When using a bench top rotary evaporator there is always a chance the solution may foam, splash, or bump from the flask. This always results in a large mess which contaminates the condenser and receiving flask, requiring a time-consuming clean up. For safety and prevention, the solution is to insert a bump trap between the flask and vapor duct, isolating solvents from contacting the condenser and receiving flask. The bump trap will contain any foam, splashes, or bumped solvents in the bulb which then can easily be returned to the flask. All bump traps are made of heavy wall borosilicate glass with high-quality, durable, reinforced standard taper joints.

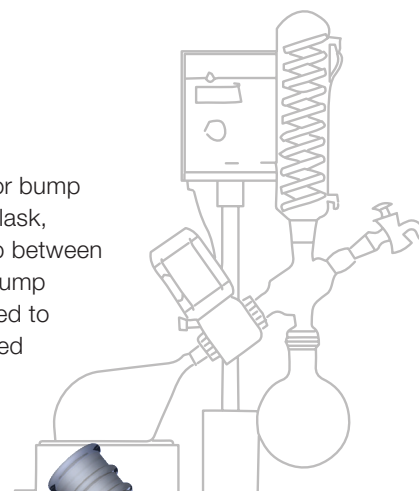

Anti-Splash

- Greatly reduces carry-over from foaming or bumping.

Length, mm.	ST Joint		Order Code
	Top Outer	Bottom Inner	
100mL Capacity			
145	24/40	14/20	6704-04
175	24/40	24/40	6704-08
145	29/42	14/20	6704-12
250mL Capacity			
200	24/40	24/40	6704-16
200	29/42	29/42	6704-20
500mL Capacity			
215	24/40	24/40	6704-24

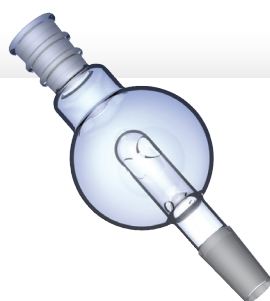

Anti-Splash, Improved

- Greatly reduces carry-over from foaming or bumping.
- Two drain holes to expedite the return of solvent to the evaporator flask.

Length, mm.	ST Joint		Order Code
	Top Outer	Bottom Inner	
100mL Capacity			
145	24/40	14/20	6705-06
175	24/40	24/40	6705-10
250mL Capacity			
200	24/40	24/40	6705-14
200	29/42	29/42	6705-22
500mL Capacity			
215	24/40	24/40	6705-26

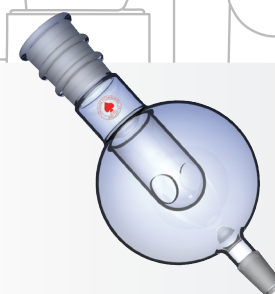

Anti-Climb

- Upper tubulation prevents migration of film and foam directly into the condenser.

Length, mm.	ST Joint		Order Code
	Top Outer	Bottom Inner	
100mL Capacity			
160	24/40	14/20	6706-05
190	24/40	24/40	6706-09
250mL Capacity			
180	24/40	14/20	6706-13
215	24/40	24/40	6706-17
500mL Capacity			
215	29/42	29/42	6706-21



Rotavap Bump Traps

When using a bench top rotary evaporator there is always a chance the solution may foam, splash, or bump from the flask. This always results in a large mess which contaminates the condenser and receiving flask, requiring a time-consuming clean up. For safety and prevention, the solution is to insert a bump trap between the flask and vapor duct, isolating solvents from contacting the condenser and receiving flask. The bump trap will contain any foam, splashes, or bumped solvents in the bulb which then can easily be returned to the flask. All bump traps are made of heavy wall borosilicate glass with high-quality, durable, reinforced standard taper joints.

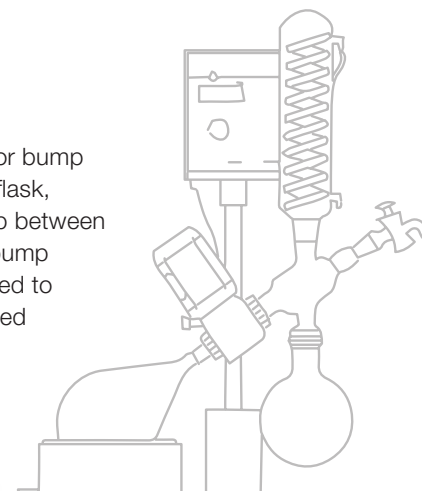

Boulanger, Self Washing

- Prevents blow-through and enables continuous addition.
- Center hole allows complete drainage of the evaporator shaft.
- Solvent vapor rapidly flows out while condensed solvent continuously rinses.
- The trap walls and the evaporator shaft return any material to the flask.

Length, mm.	ST Joint		Order Code
	Top Outer	Bottom Inner	
100mL Capacity			
165	24/40	14/20	6703-05
185	24/40	24/40	6703-10
250mL Capacity			
195	24/40	14/20	6703-15
215	24/40	24/40	6703-20
215	29/42	29/42	6703-25

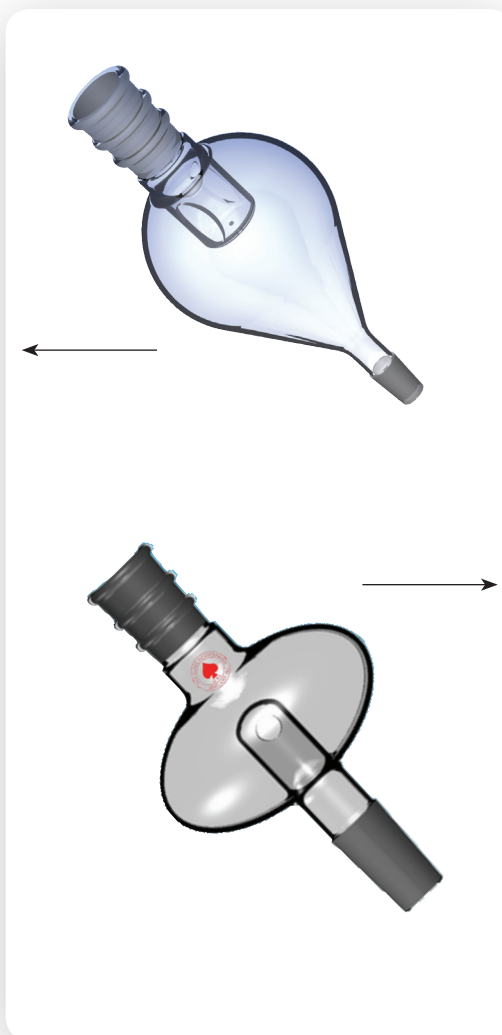

Elliptical

- Space-saving, elliptical shape.
- Shape allows for the same effect as standard traps, but with less space between the flask and evaporator tube.
- Allows for use of larger flasks in the Rotary Evaporator bath.
- Prevents fluid from being drawn into the condenser.

Length, mm.	ST Joint		Order Code
	Top Outer	Bottom Inner	
250mL Capacity			
173	24/40	24/40	6710-01
179	29/42	29/42	6710-05
159	29/32	29/32	6710-07

Contact us today to learn more about our full line of Rotary Evaporator Glassware!



www.aceglass.com

1430 Northwest Boulevard
Vineland, NJ 08360

sales@aceglass.com
P: (800) 223-4524
F: (800) 543-6752